

### Conduit Bodies - Form 7

#### Features:

- Exterior PVC coating thickness is a minimum 0.040"
- Interior urethane coating thickness is a minimum 0.002"
- Specialized corrosion resistant coating provided on threads
- Fittings are supplied with plastic encapsulated stainless steel screws

#### Standards:

- UL Standard 514B
- CSA Standard: C22.2 No. 18

#### Applications:

Calbond offers the full line of C Form 7 PVC Coated Conduit Bodies. Conduit Bodies are installed in conduit systems to; act as pull outlets for conductors being installed, provide openings for making splices in conductors, and to provide access to conductors for maintenance and future system changes. All fittings are supplied with PVC coated cast iron covers. The sleeved threaded ends offer complete protection against corrosion while maintaining full ground continuity throughout the installed system.

### C Form 7

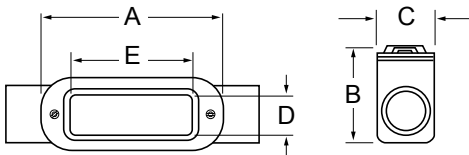

Part Number	Trade Size (in)	Metric Size (mm)	A (in)	B (in)	C (in)	D (in)	E (in)	Weight / 100 (lb)
PV0500C17	½	16	6.38	1.42	1.46	0.94	3.19	100
PV0700C27	¾	21	7.50	1.67	1.64	1.13	3.81	140
PV1000C37	1	27	9.00	1.92	1.83	1.38	4.50	220
PV1200C47	1¼	35	9.94	2.35	2.27	1.75	5.00	270
PV1500C57	1½	41	11.19	2.60	2.52	1.94	5.44	400
PV2000C67	2	53	11.19	3.17	3.08	2.44	6.38	550
PV2500C77	2½	63	14.00	3.67	4.33	3.56	8.38	1,000
PV3000C87	3	78	13.75	4.42	4.33	3.56	8.38	1,180

All dimensions are for informational purposes only \*Tolerances +/- 5%



## Conduit Bodies - Form 7

### LB Form 7

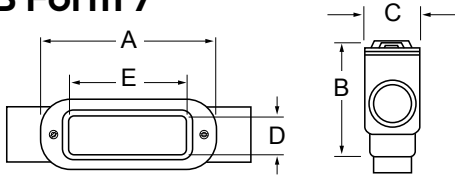

Part Number	Trade Size (in)	Metric Size (mm)	A (in)	B (in)	C (in)	D (in)	E (in)	Weight / 100 (lb)
PV0500LB17	½	16	5.10	2.29	1.42	0.94	3.19	110
PV0700LB27	¾	21	5.98	2.54	1.60	1.13	3.81	170
PV1000LB37	1	27	7.01	2.92	1.79	1.38	4.50	220
PV1200LB47	1¼	35	7.79	3.35	2.23	1.75	5.00	310
PV1500LB57	1½	41	8.67	3.73	2.48	1.94	5.44	380
PV2000LB67	2	53	10.17	4.29	3.04	2.44	6.38	520
PV2500LB777	2½	63	12.54	5.17	4.29	3.56	8.38	1,000
PV3000LB87	3	78	12.54	5.92	4.29	3.56	8.38	1,300
PV3500LB97	3½	91	14.73	6.60	5.29	4.50	10.25	1,900
PV4000LB107	4	103	14.73	7.10	5.29	4.50	10.25	1,850

All dimensions are for informational purposes only \*Tolerances +/- 5%



### LL Form 7

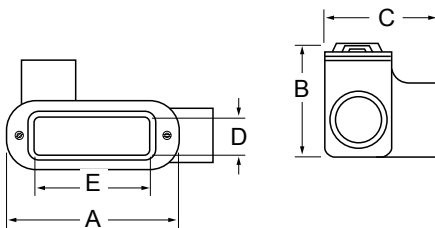

Part Number	Trade Size (in)	Metric Size (mm)	A (in)	B (in)	C (in)	D (in)	E (in)	Weight / 100 (lb)
PV0500LL17	½	16	5.10	1.42	2.29	0.94	3.19	120
PV0700LL27	¾	21	5.98	1.67	2.48	1.13	3.81	160
PV1000LL37	1	27	7.04	1.92	2.49	1.38	4.50	210
PV1200LL47	1¼	35	7.79	2.35	3.23	1.75	5.00	300
PV1500LL57	1½	41	8.67	2.60	3.60	1.94	5.44	410
PV2000LL67	2	53	10.17	3.17	4.17	2.44	6.38	570
PV2500LL777	2½	63	12.54	3.67	5.79	3.56	8.38	1,000
PV3000LL87	3	78	12.54	4.42	5.79	3.56	8.38	1,270
PV3500LL97	3½	91	14.73	4.92	6.98	4.50	10.25	1,900
PV4000LL107	4	103	14.73	5.42	6.98	4.50	10.25	1,900

All dimensions are for informational purposes only \*Tolerances +/- 5%



### LR Form 7

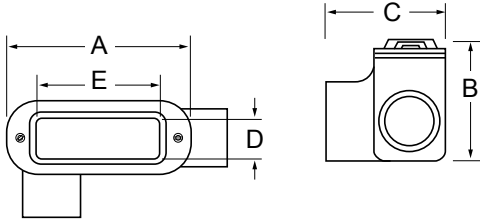

Part Number	Trade Size (in)	Metric Size (mm)	A (in)	B (in)	C (in)	D (in)	E (in)	Weight / 100 (lb)
PV0500LR17	½	16	5.10	1.42	2.29	0.94	3.19	120
PV0700LR27	¾	21	5.98	1.67	2.49	1.13	3.81	160
PV1000LR37	1	27	7.04	1.92	2.79	1.38	4.50	210
PV1200LR47	1¼	35	7.79	2.35	3.23	1.75	5.00	300
PV1500LR57	1½	41	8.67	2.60	3.60	1.94	5.44	410
PV2000LR67	2	53	10.17	3.17	4.17	2.44	6.38	570
PV2500LR777	2½	63	12.54	3.67	5.79	3.56	8.38	1,000
PV3000LR87	3	78	12.54	4.42	5.79	3.56	8.38	1,270
PV3500LR97	3½	91	14.73	4.42	6.98	4.50	10.25	1,900
PV4000LR107	4	103	14.73	5.42	6.98	4.50	10.25	1,900

All dimensions are for informational purposes only \*Tolerances +/- 5%



### T Form 7

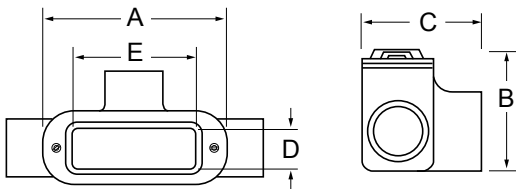

Part Number	Trade Size (in)	Metric Size (mm)	A (in)	B (in)	C (in)	D (in)	E (in)	Weight / 100 (lb)
PV0500T17	½	16	6.63	1.79	2.48	0.94	3.19	150
PV0700T27	¾	21	7.75	2.04	2.67	1.13	3.81	210
PV1000T37	1	27	9.25	2.29	3.04	1.38	4.50	290
PV1200T47	1¼	35	9.94	2.35	3.23	1.75	5.00	360
PV1500T57	1½	41	11.19	2.60	3.60	1.94	5.44	450
PV2000T67	2	53	13.19	3.17	4.17	2.44	6.38	650
PV2500T777	2½	63	16.00	3.67	5.79	3.56	8.38	1,070
PV3000T87	3	78	16.06	4.42	5.79	3.56	8.38	1,540
PV3500T97	3½	91	18.31	4.92	6.98	4.50	10.25	1,900
PV4000T107	4	103	18.31	5.42	6.98	4.50	10.25	2,100

All dimensions are for informational purposes only \*Tolerances +/- 5%



# Conduit Bodies - Form 7

## TB Form 7

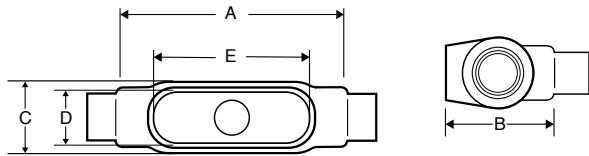

Part Number	Trade Size (in)	Metric Size (mm)	A (in)	B (in)	C (in)	D (in)	E (in)	Weight / 100 (lb)
PV0500TB17	½	16	6.63	2.67	1.64	0.94	3.19	160
PV0700TB27	¾	21	7.75	2.92	1.83	1.13	3.81	210
PV1000TB37	1	27	9.25	3.29	2.08	1.38	4.50	270
PV1200TB47	1¼	35	9.94	3.35	2.27	1.75	5.00	370
PV1500TB57	1½	41	11.19	5.04	2.52	1.94	5.44	470
PV2000TB67	2	53	13.19	6.17	3.08	2.44	6.38	700

All dimensions are for informational purposes only \*Tolerances +/- 5%



## X Form 7

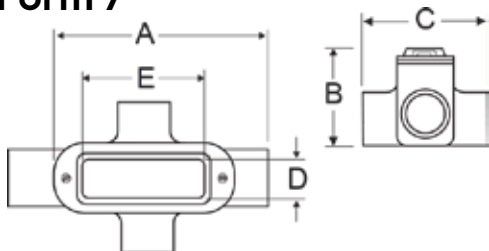

Part Number	Trade Size (in)	Metric Size (mm)	A (in)	B (in)	C (in)	D (in)	E (in)	Weight / 100 (lb)
PV0500X17SA	½	16	6.63	3.35	1.79	0.94	3.19	170
PV0700X27SA	¾	21	7.75	3.54	2.04	1.13	3.81	240
PV1000X37SA	1	27	9.25	4.04	2.29	1.38	4.50	270
PV1200X47SA	1¼	35	9.94	4.17	2.35	1.75	5.00	360
PV1500X57SA	1½	41	11.19	4.67	2.60	1.94	5.44	500
PV2000X67SA	2	53	13.90	5.23	3.17	2.44	6.38	750

All dimensions are for informational purposes only \*Tolerances +/- 5%

