

# MALLEABLE IRON THREADED CONDUIT BODIES

FOR THREADED RIGID CONDUIT AND IMC

## APPLICATION

To provide access to conductors for pulling, splicing, and maintenance. Threaded for rigid conduit and IMC.

## FEATURES

- Tapered threaded hubs (NPT)
- Flat back design for easy mounting close to walls
- Suitable for use in concrete

## STANDARD MATERIALS

Malleable Iron

## STANDARD FINISH

Zinc Plated



### TYPE C1

CATALOG NUMBER	TRADE SIZE	DIM A	DIM B	DIM C	MAX WIRE SIZE	VOL. CU.IN.	UNIT PACK	MASTER PACK	LBS. / 100 PCS.	UPC #
<b>C TYPE</b>										
<b>C1</b>	1/2"	5.375	1.313	1.375	N/A	4.50	10	50	98	43010
<b>C2</b>	3/4"	6.000	1.500	1.688	3 #6 AWG	7.50	10	50	118	43020
<b>C3</b>	1"	7.063	1.813	1.875	3 #4 AWG	12.50	5	25	170	43030
<b>C4</b>	1-1/4"	9.000	2.625	2.750	3 #2 AWG	32.30	—	10	309	43040
<b>C5</b>	1-1/2"	9.000	2.625	2.813	3 #1/0 AWG	35.30	—	10	368	43050
<b>C6</b>	2"	11.500	3.125	3.313	3 #4/0 AWG	73.00	—	5	553	43060
<b>C7</b>	2-1/2"	15.000	4.313	3.875	3 #250 MCM	138.00	—	1	1216	43070
<b>C8</b>	3"	15.125	4.313	4.750	3 #250 MCM	170.00	—	1	1437	43080
<b>C9</b>	3-1/2"	18.125	4.875	5.625	3 #350 MCM	300.00	—	1	2210	43090
<b>C10</b>	4"	18.125	4.875	5.625	3 #350 MCM	328.00	—	1	2321	43100

## OPTIONAL FINISH

For additional corrosion protection, specify Hot Dipped Galvanized. Add suffix 'G' to Malleable Iron catalog number. Example LB1G. For more information, see page 11.

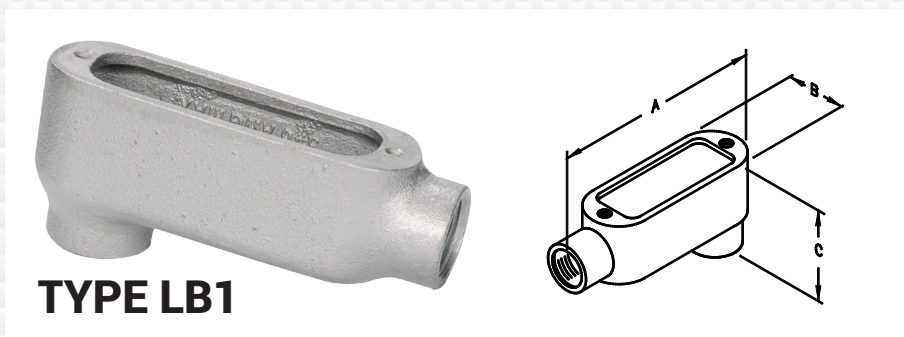

### TYPE LB1

CATALOG NUMBER	TRADE SIZE	DIM A	DIM B	DIM C	MAX WIRE SIZE	VOL. CU.IN.	UNIT PACK	MASTER PACK	LBS. / 100 PCS.	UPC #
<b>LB TYPE</b>										
<b>LB1</b>	1/2"	4.688	1.313	2.063	N/A	4.50	10	50	71	40011
<b>LB2</b>	3/4"	5.375	1.500	2.250	3 #6 AWG	7.50	10	50	97	40021
<b>LB3</b>	1"	6.188	1.813	2.625	3 #4 AWG	12.50	5	25	143	40031
<b>LB4</b>	1-1/4"	8.125	2.625	2.750	3 #2 AWG	32.30	—	10	287	40041
<b>LB5</b>	1-1/2"	8.125	2.625	2.813	3 #1/0 AWG	35.30	—	10	332	40051
<b>LB6</b>	2"	10.500	3.125	4.438	3 #4/0 AWG	73.00	—	5	534	40061
<b>LB7</b>	2-1/2"	13.625	4.313	5.375	3 #350 AWG	138.00	—	1	1105	40071
<b>LB8</b>	3"	13.875	4.313	5.875	3 #350 AWG	170.00	—	1	1160	40081
<b>LB9</b>	3-1/2"	16.250	5.625	6.875	3 #500 MCM	300.00	—	1	1989	40091
<b>LB10</b>	4"	16.625	5.625	7.188	3 #500 MCM	328.00	—	1	2100	40101

# MALLEABLE IRON THREADED CONDUIT BODIES

FOR THREADED RIGID CONDUIT AND IMC

### APPLICATION

To provide access to conductors for pulling, splicing, and maintenance. Threaded for rigid conduit and IMC.

### FEATURES

- Tapered threaded hubs (NPT)
- Flat back design for easy mounting close to walls
- Suitable for use in concrete

### STANDARD MATERIALS

Malleable Iron

### STANDARD FINISH

Zinc Plated



**TYPE LL1**

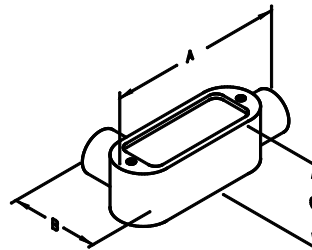

CATALOG NUMBER	TRADE SIZE	DIM A	DIM B	DIM C	MAX WIRE SIZE	VOL. CU.IN.	UNIT PACK	MASTER PACK	LBS. / 100 PCS.	UPC #
<b>LL TYPE</b>										
LL1	1/2"	4.688	2.063	1.375	N/A	4.50	10	50	76	41011
LL2	3/4"	5.375	2.250	1.688	3 #6 AWG	7.50	10	50	95	41021
LL3	1"	6.188	2.625	1.875	3 #4 AWG	12.50	5	25	138	41031
LL4	1-1/4"	8.125	2.750	2.750	3 #2 AWG	32.30	—	10	309	41041
LL5	1-1/2"	8.125	3.500	2.813	3 #1/0 AWAG	35.30	—	10	332	41051
LL6	2"	10.500	4.125	3.313	3 #4/0 AWG	73.00	—	5	497	41061
LL7	2-1/2"	13.625	4.688	3.875	3 #300 MCM	138.00	—	1	1105	41071
LL8	3"	13.875	5.875	4.750	3 #350 MCM	170.00	—	1	1437	41081
LL9	3-1/2"	16.250	6.125	5.625	3 #350 MCM	300.00	—	1	2321	41091
LL10	4"	16.250	6.938	5.625	3 #350 MCM	328.00	—	1	2431	41101

### OPTIONAL FINISH

For additional corrosion protection, specify Hot Dipped Galvanized. Add suffix 'G' to Malleable Iron catalog number. Example LL1G. For more information, see page 12.



**TYPE LR1**

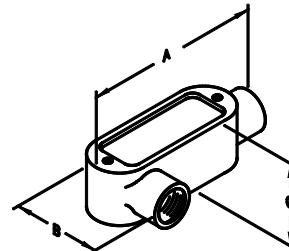

CATALOG NUMBER	TRADE SIZE	DIM A	DIM B	DIM C	MAX WIRE SIZE	VOL. CU.IN.	UNIT PACK	MASTER PACK	LBS. / 100 PCS.	UPC #
<b>LR TYPE</b>										
LR1	1/2"	4.688	2.063	1.375	N/A	4.50	10	50	71	42011
LR2	3/4"	5.375	2.250	1.688	3 #6 AWG	7.50	10	50	100	42021
LR3	1"	6.188	2.625	1.875	3 #4 AWG	12.50	5	25	157	42031
LR4	1-1/4"	8.125	2.750	2.750	3 #2 AWG	32.30	—	10	332	42041
LR5	1-1/2"	8.125	2.813	2.813	3 #1/0 AWAG	35.30	—	10	345	42051
LR6	2"	10.500	4.438	3.313	3 #4/0 AWG	73.00	—	5	626	42061
LR7	2-1/2"	13.625	5.375	3.875	3 #300 MCM	138.00	—	1	1105	42071
LR8	3"	13.875	5.875	4.750	3 #350 MCM	170.00	—	1	1437	42081
LR9	3-1/2"	16.250	6.875	5.625	3 #350 MCM	300.00	—	1	2321	42091
LR10	4"	16.625	7.188	5.625	3 #350 MCM	328.00	—	1	2500	42101

# MALLEABLE IRON THREADED CONDUIT BODIES

FOR THREADED RIGID CONDUIT AND IMC

## APPLICATION

To provide access to conductors for pulling, splicing, and maintenance. Threaded for rigid conduit and IMC.

## FEATURES

- Tapered threaded hubs (NPT)
- Flat back design for easy mounting close to walls
- Suitable for use in concrete

## STANDARD MATERIALS

Malleable Iron

## STANDARD FINISH

Zinc Plated

## OPTIONAL FINISH

For additional corrosion protection, specify Hot Dipped Galvanized. Add suffix 'G' to Malleable Iron catalog number. Example T1G. For more information, see page 13.

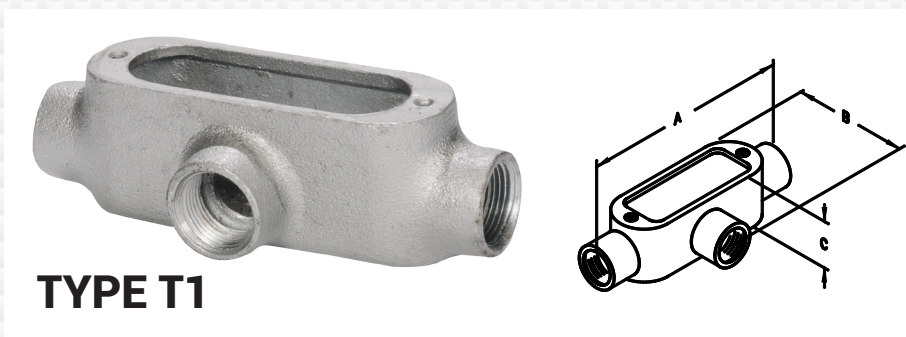

**TYPE T1**

CATALOG NUMBER	TRADE SIZE	DIM A	DIM B	DIM C	MAX WIRE SIZE	VOL. CU.IN.	UNIT PACK	MASTER PACK	LBS. / 100 PCS.	UPC #
<b>T TYPE</b>										
T1	1/2"	5.375	2.063	1.313	N/A	6.00	10	50	111	44011
T2	3/4"	6.000	2.250	1.500	3 #6 AWG	9.50	10	50	137	44021
T3	1"	7.063	2.625	1.813	3 #4 AWG	15.00	5	25	195	44031
T4	1-1/4"	9.000	2.750	2.625	3 #2 AWG	33.00	—	10	332	44041
T5	1-1/2"	9.000	3.500	2.625	3 #2 AWG	36.00	—	10	368	44051
T6	2"	11.500	4.125	3.125	3 #1/0 AWG	75.00	—	5	663	44061
T7	2-1/2"	15.000	5.688	4.313	3 #4/0 AWG	138.00	—	1	1271	44071
T8	3"	15.125	5.875	4.313	3 #4/0 AWG	170.00	—	1	1547	44081
T9	3-1/2"	18.125	6.813	4.875	3 #350 MCM	300.00	—	1	2542	44091
T10	4"	18.125	7.188	4.875	3 #350 MCM	328.00	—	1	2542	44101



**TYPE TB1**

CATALOG NUMBER	TRADE SIZE	DIM A	DIM B	DIM C	MAX WIRE SIZE	VOL. CU.IN.	UNIT PACK	MASTER PACK	LBS. / 100 PCS.	UPC #
<b>TB Type</b>										
TB1	1/2"	5.250	1.313	1.313	N/A	6	10	50	88	64011
TB2	3/4"	6.063	1.563	1.563	3 #6 AWG	9.5	10	50	120	64012
TB3	1"	7.125	1.813	1.813	3 # 4 AWG	15	5	25	197	64013
TB4	1-1/4"	9.313	2.438	3.750	3 # 2 AWG	33	-	10	343	64014
TB5	1-1/2"	9.313	2.563	3.750	3 #2 AWG	36	-	10	420	64015
TB6	2"	11.813	3.188	4.125	3 # 1/0 AWG	75	-	5	691	64016

# CONDUIT BODY COVERS

## STEEL AND ALUMINUM COVERS

### APPLICATION

Used with conduit bodies to cover opening.

### FEATURES

- Assembled with captive zinc plated steel screws.

### STANDARD MATERIALS

Steel

### STANDARD FINISH

Zinc plated



**TYPE 02**

CATALOG NUMBER	TRADE SIZE	DIM A	DIM B	UNIT PACK	MASTER PACK	LBS. / 100 PCS.	UPC #
<b>Steel Covers</b>							
01	1/2"	3.875	1.310	25	250	9	49017
02	3/4"	4.625	1.520	25	250	13	49027
03	1"	5.315	1.710	20	200	19	49037
04	1-1/4" - 1-1/2"	7.240	2.510	25	100	31	49047
05	2"	9.484	3.110	-	50	50	49057
06	2-1/2" - 3"	14.937	5.500	-	10	94	49067
07	3-1/2" - 4"	15.000	6.000	-	10	138	49077

### APPLICATION

Used with conduit bodies to cover opening.

### FEATURES

- Assembled with captive zinc plated steel screws.
- Stamped from high-strength aluminum, corrosion and weather resistant copperfree aluminum alloy.

### STANDARD MATERIALS

Stamped Aluminum



**TYPE 02A**

CATALOG NUMBER	TRADE SIZE	DIM A	DIM B	UNIT PACK	MASTER PACK	LBS. / 100 PCS.	UPC #
<b>Aluminum Covers</b>							
01A	1/2"	3.90	1.37	25	250	6	49105
02A	3/4"	4.70	1.60	25	250	10	49205
03A	1"	5.40	1.78	20	200	14	49305
04A	1-1/4" - 1-1/2"	7.25	2.52	25	100	18	49405
05A	2"	9.50	3.11	-	50	20	49505
06A	2-1/2" - 3"	12.13	4.45	-	10	33	49605
07A	3-1/2" - 4"	14.94	5.50	-	10	62	49705

# CONDUIT BODY COVERS

## NEOPRENE GASKETS

### APPLICATION

→ Gasket used with conduit bodies for a raintight seal.

### STANDARD MATERIALS

Neoprene Rubber

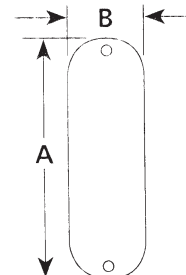

**TYPE 11**

CATALOG NUMBER	TRADE SIZE	DIM A	DIM B	UNIT PACK	MASTER PACK	LBS. / 100 PCS.	UPC #
<b>Neoprene Gaskets</b>							
10	1/2"	3.90	1.37	200	2000	3	49910
11	3/4"	4.60	1.56	100	1000	3	49911
12	1"	5.34	1.73	100	1000	3	49912
13	1-1/4" - 1-1/2"	7.25	2.51	50	500	6	49913
14	2"	9.50	3.05	25	100	11	49914
15	2-1/2" - 3"	12.13	4.39	-	10	13	49915
16	3-1/2" - 4"	14.88	5.43	-	10	28	49916