

Part Number with Hardware Explanation

Note: All hardware is 3/8"

- Example:** 9F-4004 SS6: pair of 4-hole splice plates for 4" (101) system with stainless steel hardware
 9FV-8006 SS6: pair of 8-hole vinyl ester splice plates for 6" (152) system with stainless steel hardware

Hardware Option	316 Stainless Steel
	SS6

Standard Lay-In Splice Plates

- Furnished in pairs with 316 stainless steel hardware
- One pair including hardware provided with straight section. (Expansion splice quantity subtracted)

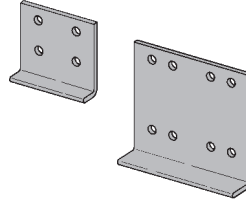

Material	Height in. (mm)	Catalog No.
Fiberglass	3" (76)	9(Δ)-4003SS6
	4" (101)	9(Δ)-4004SS6
	6" (152)	9(Δ)-8006SS6
	8" (203)	9(Δ)-8008SS6

Expansion Lay-In Splice Plates

- Furnished in pairs with 316 stainless steel hardware

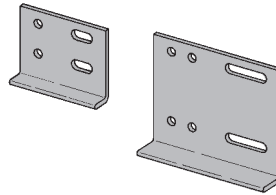

Material	Height in. (mm)	Catalog No.
Fiberglass	3" (76)	9(Δ)-4013SS6
	4" (101)	9(Δ)-4014SS6
	6" (152)	9(Δ)-8016SS6
	8" (203)	9(Δ)-8018SS6

Tray to Box Splice Plates

These plates are used to attach the end of a tray run to a distribution box or control center.

- Furnished in pairs with 316 stainless steel hardware

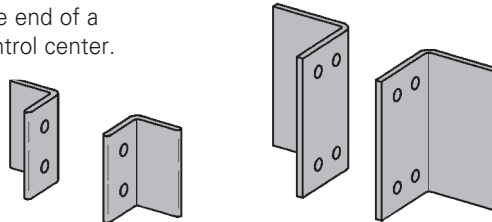

Material	Height in. (mm)	Catalog No.
Fiberglass	3" (76)	9(Δ)-4053SS6
	4" (101)	9(Δ)-4054SS6
	6" (152)	9(Δ)-8056SS6
	8" (203)	9(Δ)-8058SS6

Step Down Splice Plates

These plates are offered for connecting cable tray sections having side rails of different heights.

- Furnished in pairs with 316 stainless steel hardware

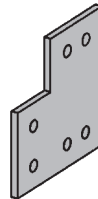

Material	Height in. (mm)	Catalog No.
Fiberglass	8" to 6" (203 to 152)	9(Δ)-8086SS6
	8" to 4" (203 to 101)	9(Δ)-8084SS6
	6" to 3" (152 to 76)	9(Δ)-8063SS6
	6" to 4" (152 to 101)	9(Δ)-8064SS6
	4" to 3" (101 to 76)	9(Δ)-4043SS6

Blind End Plate

This plate forms a closure for any tray that dead ends.

- Furnished as one plate
- W = tray width

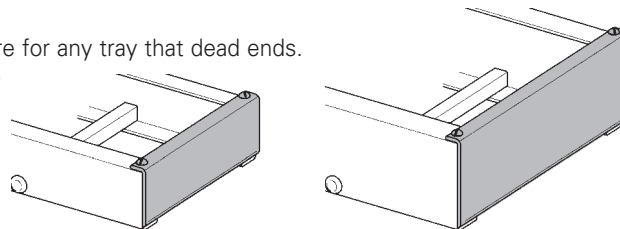

Material	Height in. (mm)	Catalog No.
Fiberglass	3" (76)	9(Δ)-1083-WSS6
	4" (101)	9(Δ)-1084-WSS6
	6" (152)	9(Δ)-1086-WSS6
	8" (203)	9(Δ)-1088-WSS6

Resin Seal Kit

To reseal fiberglass after field modifications.

- 1 pint (473ml)
- Contents: Sealant and Applicator.



Catalog No.
RSK-010

Fiberglass - Accessories

Horizontal Adjustable Splice Plates

These plates provide for changes in the horizontal direction that do not conform to standard fittings.

- Furnished in pairs with 316 stainless steel hardware
- Body made from 316 stainless steel
- Used for all material finishes

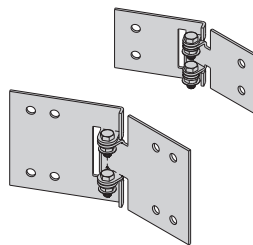

Material	Height in. (mm)	Catalog No.
Fiberglass	3" (76)	9F-403SS6
	4" (101)	9F-4034SS6
	6" (152)	9F-8036SS6
	8" (203)	9F-8038SS6

Horizontal Splice Plates

- Furnished in pairs with 316 stainless steel hardware

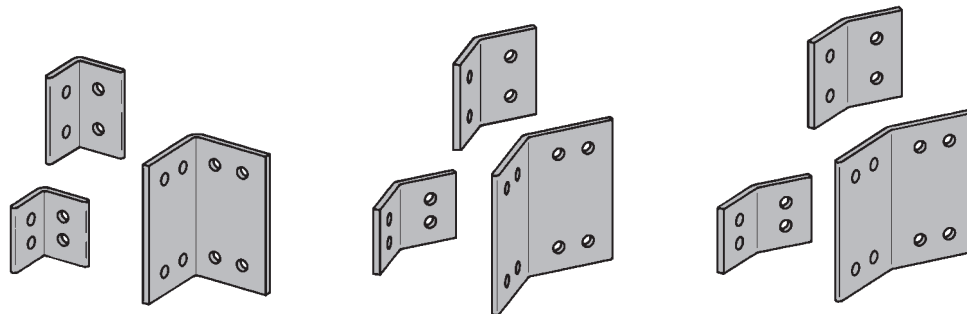

Material	Height in. (mm)	Catalog No.		
		90°	45°	30°
Fiberglass	3" (76)	9(Δ)-4903HSS6	9(Δ)-4453HSS6	9(Δ)-4303HSS6
	4" (101)	9(Δ)-4904HSS6	9(Δ)-4454HSS6	9(Δ)-4304HSS6
	6" (152)	9(Δ)-8906HSS6	9(Δ)-8456HSS6	9(Δ)-8306HSS6
	8" (203)	9(Δ)-8908HSS6	9(Δ)-8458HSS6	9(Δ)-8308HSS6

Vertical Adjustable Splice Plates

These plates provide for changes in elevation that do not conform to standard vertical fittings.

- Furnished in pairs with 316 stainless steel hardware

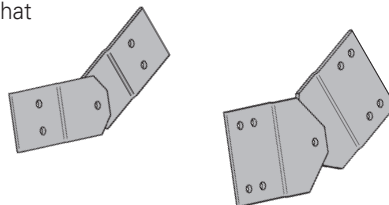

Material	Height in. (mm)	Catalog No.
Fiberglass	3" (76)	9(Δ)-4023SS6
	4" (101)	9(Δ)-4024SS6
	6" (152)	9(Δ)-8026SS6
	8" (203)	9(Δ)-8028SS6

Vertical Splice Plates

- Furnished in pairs with 316 stainless steel hardware

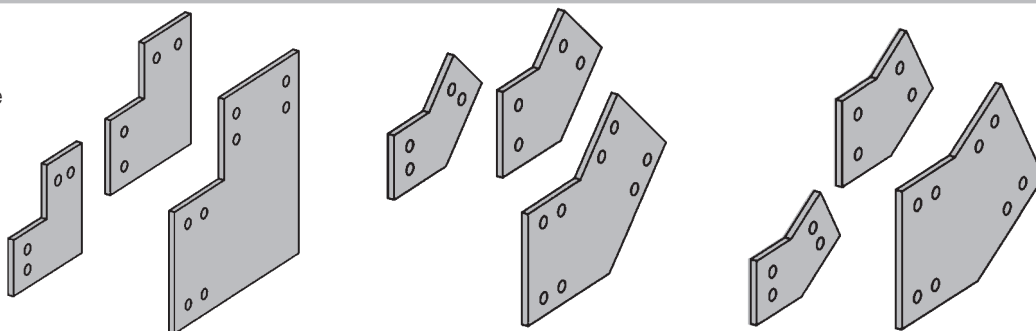

Material	Height in. (mm)	Catalog No.		
		90°	45°	30°
Fiberglass	3" (76)	9(Δ)-4903VSS6	9(Δ)-4453VSS6	9(Δ)-4303VSS6
	4" (101)	9(Δ)-4904VSS6	9(Δ)-4454VSS6	9(Δ)-4304VSS6
	6" (152)	9(Δ)-8906VSS6	9(Δ)-8456VSS6	9(Δ)-8306VSS6
	8" (203)	9(Δ)-8908VSS6	9(Δ)-8458VSS6	9(Δ)-8308VSS6

(Δ) See page M-31 for material selection

Dimensions shown in parentheses are in millimeters, unless otherwise specified.

Ladder Drop-Out

Specially-designed Ladder Drop-Outs provide a rounded surface with adequate radius to protect cable as it exits from the tray, preventing damage to insulation.

- 4" (101) radius
- W = tray width
- Furnished with #10 x 3/4" self-drilling stainless steel screws

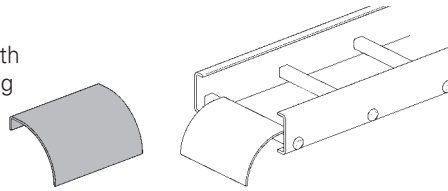

Catalog No.

9(Δ)-1104-W

Barriers

- Furnished with #10 x 3/4" self-drilling stainless steel screws

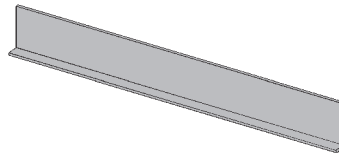

Catalog No.	Side Rail Height in. (mm)
72(Δ)-120	3" (76)
73(Δ)-120	4" (101)
75(Δ)-120	6" (152)
77(Δ)-120	8" (203)

Flexible Horizontal Barrier Kit

One kit allows up to a 36" (914) radius position of the barrier.

Kit Contents:

- 1 pc — 72" (1829) Straight Barrier
 - 4 pc — 9F-9002 Barrier Strip Clip
 - 8 pc — Thermo Plastic Drive Rivet
 - 4 pc — #10 x 3/4" Stainless Steel Self-Drilling Screw
- Assembly required — directions included.

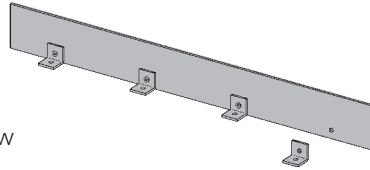

Catalog No.	Side Rail Height in. (mm)
72(Δ)-90HBFL	3" (76)
73(Δ)-90HBFL	4" (101)
75(Δ)-90HBFL	6" (152)
77(Δ)-90HBFL	8" (203)

Vertical Bend Barriers

- Furnished with #10 x 3/4" self-drilling stainless steel screws
- * Insert 2 for 3" (76) siderail height
- 3 for 4" (101) siderail height
- 5 for 6" (152) siderail height

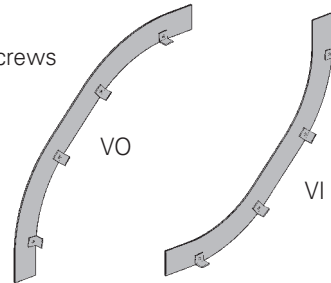

7* (Δ) - 90 VO 24



Clamp/Guide - Fiberglass

- Nonmetallic
- Designed for 3/8" hardware - not included
- Combination hold down clamp and guide
- Material: Glass reinforced polyurethane
- Sold in pairs

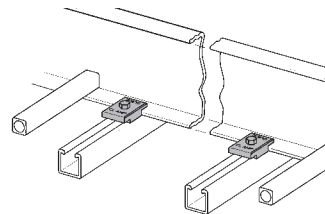

Catalog No.

9F-1208

Fiberglass Conduit to Cable Tray Adapter

- For rigid or PVC conduit
- Furnished in pairs with 316 stainless steel hardware

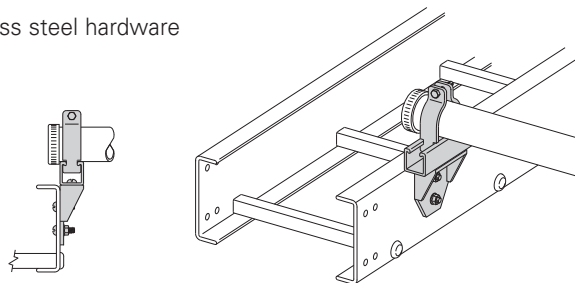

Catalog No.	Conduit Size in. (mm)
9FV-2008	0.50 (15)
9FV-2009	0.75 (20)
9FV-2010	1.00 (25)
9FV-2011	1.25 (32)
9FV-2012	1.50 (40)
9FV-2013	2.00 (50)
9FV-2014	2.50 (65)
9FV-2015	3.00 (80)
9FV-2016	3.50 (90)
9FV-2017	4.00 (100)

(Δ) See page M-31 for material selection

Dimensions shown in parentheses are in millimeters, unless otherwise specified.

Fiberglass - Cable Channel & Fittings

Straight Section

- Load data was interpolated from CSA testing.
- Loads shown are for FCCN series.
- Loads shown are for 6 ft. (1.83m) span with deflection of .7 (18.26) inches.
- One pair of splice plates included with each straight section.

FCC Fiberglass
Cable Channel Ventilated

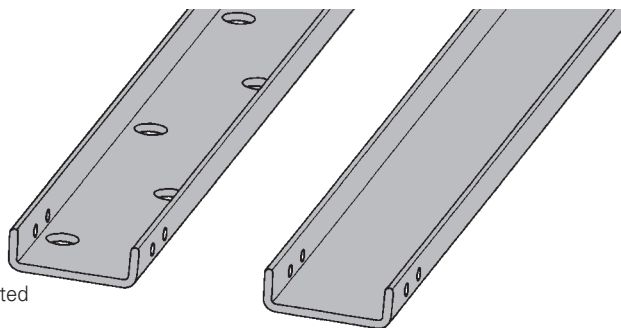

FCCN Fiberglass Cable
Channel Non-Ventilated

Catalog No.		Width in. (mm)	Length ft. (m)	Height in. (mm)	Load Lbs/Ft (kg/m)
Ventilated	Non-Ventilated				
(*)-03-120	(*)N-03-120	3 (76)	10 (3)	1 (25)	8 (12)
(*)-03-240	(*)N-03-240	3 (76)	20 (6)	1 (25)	8 (12)
(*)-04-120	(*)N-04-120	4 (101)	10 (3)	1½ (28)	12 (18)
(*)-04-240	(*)N-04-240	4 (101)	20 (6)	1½ (28)	12 (18)
(*)-06-120	(*)N-06-120	6 (152)	10 (3)	1⅝ (35)	58 (86)
(*)-06-240	(*)N-06-240	6 (152)	20 (6)	1⅝ (35)	58 (86)
(*)-08-120	(*)N-08-120	8 (203)	10 (3)	2¾ (55)	87 (129)
(*)-08-240	(*)N-08-240	8 (203)	20 (6)	2¾ (55)	87 (129)

Cable Channel Fittings

All fittings are of mitered construction with 12" (305) radius.

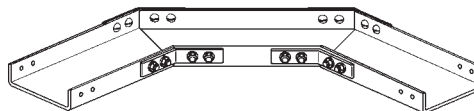

Horizontal	3" series	4" series	6" series	8" series
90°	(*)N-03-90HB12	(*)N-04-90HB12	(*)N-06-90HB12	(*)N-08-90HB12
45°	(*)N-03-45HB12	(*)N-04-45HB12	(*)N-06-45HB12	(*)N-08-45HB12

One pair of splice plates included.

Vertical	3" series	4" series	6" series	8" series
90°	(*)N-03-90V*12	(*)N-04-90V*12	(*)N-06-90V*12	(*)N-08-90V*12
45°	(*)N-03-45V*12	(*)N-04-45V*12	(*)N-06-45V*12	(*)N-08-45V*12

One pair of splice plates included.

(*) Insert material type

- FCC for Polyester Resin - available for all widths
- FCCV for Vinyl Ester Resin - available for all widths
- FCCA for Zero Halogen/Dis-Stat Resin - available for all 6" width only

● Green = Fastest shipped items ● Black = Normal lead-time items ● Red = Normally long lead-time items

Dimensions shown in parentheses are in millimeters, unless otherwise specified.

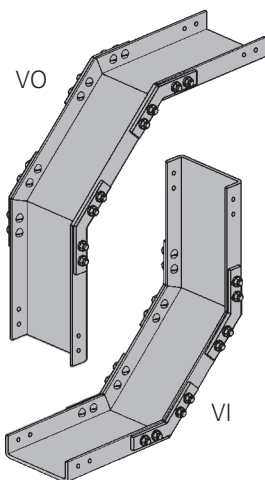

Fiberglass - Cable Channel Fittings & Accessories

Horizontal Tees

- Two pair of splice plates included.

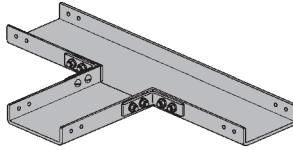

Catalog No.	Width in. (mm)
FCC(*)N-03-HT12	3 (76)
FCC(*)N-04-HT12	4 (101)
FCC(*)N-06-HT12	6 (152)
FCC(*)N-08-HT12	8 (203)

(*) See page fitting material selection bottom of page M-35

All fittings are of mitered construction with 12" (305) radius.

Horizontal Crosses

- Three pair of splice plates included.

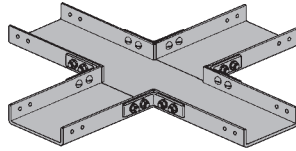

Catalog No.	Width in. (mm)
FCC(*)N-03-HX12	3 (76)
FCC(*)N-04-HX12	4 (101)
FCC(*)N-06-HX12	6 (152)
FCC(*)N-08-HX12	8 (203)

(*) See page fitting material selection bottom of page M-35

All fittings are of mitered construction with 12" (305) radius.

Splice Plates

- Sold in pairs - included with tray sections.
- Uses 1/4"-20 316SS hardware

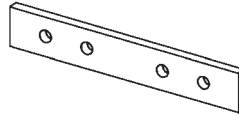

Catalog No.
9(Δ)-1001SS6

Expansion Splice Plates

- Sold in pairs
- Uses 1/4"-20 316SS hardware

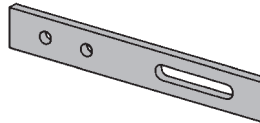

Catalog No.
9(Δ)-1013SS6

Horizontal 90° Splice Plates

- Sold in pairs
- Uses 1/4"-20 316SS hardware

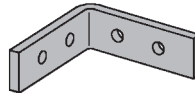

Catalog No.
9(Δ)-1901HSS6

Horizontal 45° Splice Plates

- Sold in pairs
- Uses 1/4"-20 316SS hardware

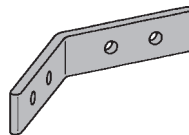

Catalog No.
9(Δ)-1451HSS6

Horizontal 30° Splice Plates

- Sold in pairs
- Uses 1/4"-20 316SS hardware

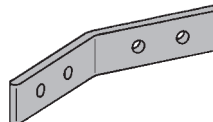

Catalog No.
9(Δ)-1301HSS6

Splice plates included with cable channel sections.
Hardware for splice plates is 1/4"-20 (316SS).

(Δ) See page M-31 for material selection

Dimensions shown in parentheses are in millimeters, unless otherwise specified.

Fiberglass - Cable Channel Accessories

Horizontal 90° Splice Plates

- Sold in pairs
- Uses 1/4"-20 316SS hardware



Catalog No.
9(Δ)-1901VSS6

Horizontal 45° Splice Plates

- Sold in pairs
- Uses 1/4"-20 316SS hardware

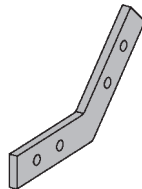

Catalog No.
9(Δ)-1451VSS6

Horizontal 30° Splice Plates

- Sold in pairs
- Uses 1/4"-20 316SS hardware

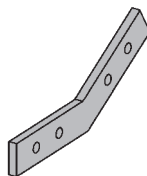

Catalog No.
9(Δ)-1301VSS6

Horizontal Adjustable Splice Plates

- Sold per piece
- Uses 3/8"-16 316SS hardware

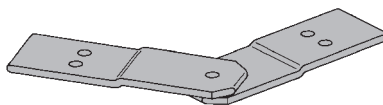

Catalog No.
9(Δ)-1023SS6

Vertical Adjustable Splice Plates

- Sold per piece
- Uses 3/8"-16 316SS hardware
- Body made from 316 stainless steel
- Used for all material finishes

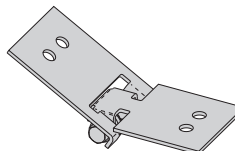

Catalog No.
9F-1033SS6

Expansion Guide Clamp

- Sold per clamp
- Order 1/2" hardware separately

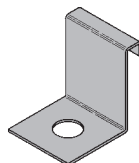

Catalog No.	Width in. (mm)
● 9SS6-1248-3	3 (76)
● 9SS6-1248-4	4 (101)
● 9SS6-1248-6	6 (152)
● 9SS6-1248-8	8 (203)

Hold-Down Clamp

- Sold per clamp
- Order 1/2" hardware separately

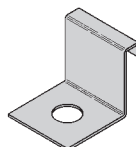

Catalog No.	Width in. (mm)
● 9SS6-1247-3	3 (76)
● 9SS6-1247-4	4 (101)
● 9SS6-1247-6	6 (152)
● 9SS6-1247-8	8 (203)

● Green = Fastest shipped items ● Black = Normal lead-time items ● Red = Normally long lead-time items

(Δ) See page M-31 for material selection

Dimensions shown in parentheses are in millimeters, unless otherwise specified.

Marine Rung Cable Tray/Fiberglass

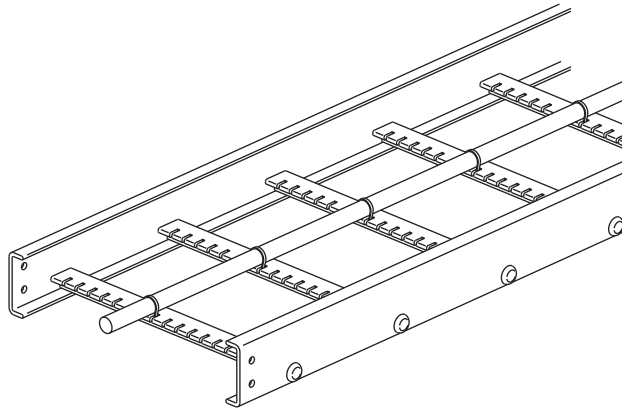

Features:

- For Coast Guard Requirements
 - Allows stainless steel banding of cables
 - $\frac{5}{32}$ " (15.9) slots 1" (25.4) on centers
 - Accommodates up to $\frac{5}{8}$ " (15.9) banding
- Has applications on land
 - Vertical installation
 - Any location where extra cable positioning is required
- Designed for Eaton's B-Line series Fiberglass Cable Trays
- Part Number Indication
 - Add MR after rung spacing
 - Example: 46F09MR-36-240

Rung design provides:

- 2" (50.8) cable support surface
- Both mechanical and adhesive rung to side rail connection

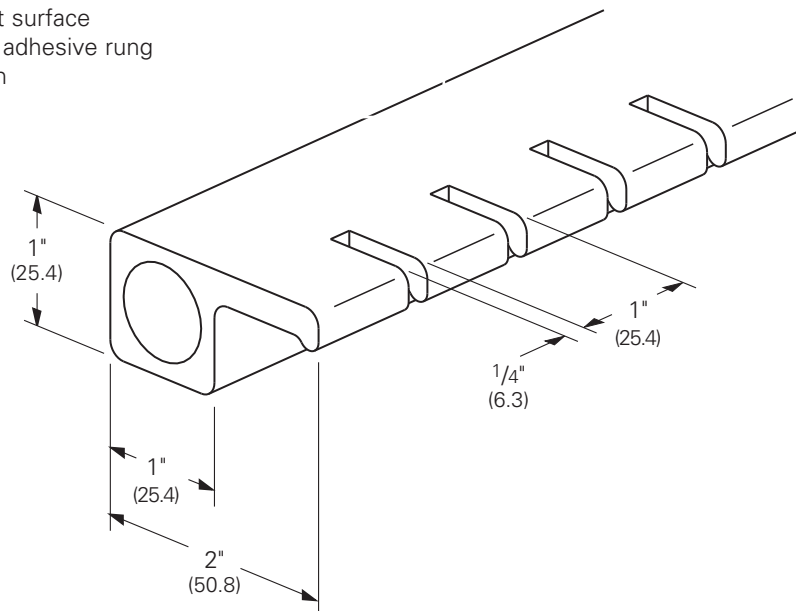

Dimensions shown in parentheses are in millimeters, unless otherwise specified.